

STEP

Operating manual



TABLE OF CONTENTS

1. EXPLANATIONS TO SYMBOLS	3
2. TECHNICAL DOCUMENTATION - ECODESIGN	4
3. TECHNICAL DATA	8
Spare part overview exploded diagram	8
Spare part overview article numbers.....	10
Dimensions	11
Amount of Fuel	11
Technical data	11
Packaging.....	11
4. IMPORTANT INFORMATION	12
General warning and safety information	12
First heating.....	12
Safety distances	12
Prior to set up	13
5. BRIEF INFORMATION ON COMBUSTIBLE - LOGS	14
Suitable fuels and fuel amounts	14
Wood types.....	14
Output controlling.....	14
Clean combustion.....	14
6. INSTALLING THE STOVE	15
Connection to the chimney	15
Connecting to a steel chimney	15
Combustion air	15
Feeding in external combustion air	15
7. OPTION REAR CONNECTION	16
Converting to rear flue pipe connection	16
8. VARIATION ROTATION	17
9. MANUAL OPERATION	18
RIKA firelighter	18
Combustion air regulation.....	18
Correct heating up.....	19
Refilling.....	19

10. CLEANING AND MAINTENANCE	20
Basic information	20
Cleaning the combustion chamber.....	20
Empty the ash drawer.....	20
Cleaning the door glass.....	20
Cleaning painted surfaces.....	20
Cleaning the convection air openings.....	20
Cleaning the flue pipes	20
Checking door seal	20
11. PROBLEMS - POSSIBLE SOLUTIONS	21
Problem 1.....	21
Problem 2.....	21
Problem 3	21
12. GUARANTEE CONDITIONS	22
13. WARRANTY CONDITIONS	22
14. DISPOSAL INFORMATION	23
Information on the individual components of the device	23
Extract from the waste code of the European Waste List Regulation	23
Electronic Waste.....	23
15. COMPLIANCE WITH EU REGULATIONS	23

1. EXPLANATIONS TO SYMBOLS



...Important note



...Useful tip



...Hexalobular #25



...Manually



...Hacksaw

Contact details of the manufacturer

Manufacturer:	RIKA Innovative Ofentechnik GmbH
Contact:	Andreas Bloderer
Address:	Müllerviertel 20 4563 Micheldorf Austria

Details of the device

Model Identifier:	STEP
Equivalent models:	-
Notified body:	Technische Universität Wien, Getreidemarkt 9/166, 1060 Wien, Austria
Notified body no.:	1746
Test report no.:	PL-17015-P
Applied harmonised standards:	EN13240:2001/A2:2004/AC:2007
Other applied standards/technical specifications:	-
Indirect heating functionality:	Nein
Direct heat output:	8 kW
Indirect heat output:	-

Characteristics when operating with the preferred fuel

Seasonal space heating energy efficiency η_s :	71,9 %
Seasonal space heating energy efficiency RIKATRONIC η_s :	-
Energy Efficiency Index:	109
Energy Efficiency Index RIKATRONIC:	-

Special precautions for assembly, installation or maintenance

Fire protection and safety distances such as distances to combustible building materials must be observed!
An adequate supply of combustion air for the appliance must be guaranteed at all times. Air-suction systems can interfere with the combustion air supply!
The flue gas values of the appliance must be observed for the chimney dimensioning!

Characteristics when operating exclusively with the preferred fuel

Heat output			
Nominal heat output	P_{nom}	8	kW
Minimum heat output	P_{min}	4	kW
Useful efficiency			
Useful efficiency at nominal heat output	$\eta_{th,nom}$	81,9	%
Useful efficiency at minimum heat output	$\eta_{th,min}$	80,5	%
Auxiliary electricity consumption*			
At nominal heat output	$e_{l,max}$	n.A.	kW
At minimum heat output	$e_{l,min}$	n.A.	kW
In standby mode	$e_{l,sB}$	n.A.	kW
Permanent pilot flame power requirement			
Pilot flame power requirement	P_{pilot}	n.A.	kW

*RIKATRONIC

Type of heat output/room temperature control	
single stage heat output, no room temperature control	Yes
two or more manual stages, no room temperature control (**)	No
with mechanic thermostat room temperature control (**)	No
with electronic room temperature control (**)	No
with electronic room temperature control plus day timer (**)	No
with electronic room temperature control plus week timer (**)	No
Room temperature control with presence detection (**)	No
Room temperature control with open window detection (**)	No
with remote control options (**)	No

Details of the fuel

Fuel	Preferred fuel:	Other suitable fuel:	η_s [%]	Space heating emissions at nominal heat output (*)				Space heating emissions at minimum heat output (*)(**)			
				PM	OGC	CO	NO _x	PM	OGC	CO	NO _x
				mg/Nm ³ (13% O ₂)				mg/Nm ³ (13% O ₂)			
Wood logs, moisture content ≤ 25 %	Yes	No	71,9	21	25	677	107	-	-	-	-
Wood logs RIKATRONIC, moisture content ≤ 25 %	No	No	-	-	-	-	-	-	-	-	-
Compressed wood, moisture content < 12 %	No	No	-	-	-	-	-	-	-	-	-
Other woody biomass	No	No	-	-	-	-	-	-	-	-	-
Non-woody biomass	No	No	-	-	-	-	-	-	-	-	-
Anthracite and dry steam coal	No	No	-	-	-	-	-	-	-	-	-
Hard coke	No	No	-	-	-	-	-	-	-	-	-
Low temperature coke	No	No	-	-	-	-	-	-	-	-	-
Bituminous coal	No	No	-	-	-	-	-	-	-	-	-
Lignite briquettes	No	No	-	-	-	-	-	-	-	-	-
Peat briquettes	No	No	-	-	-	-	-	-	-	-	-
Blended fossil fuel briquettes	No	No	-	-	-	-	-	-	-	-	-
Other fossil fuel	No	No	-	-	-	-	-	-	-	-	-
Blended biomass and fossil fuel briquettes	No	No	-	-	-	-	-	-	-	-	-
Other blend of biomass and solid fuel	No	No	-	-	-	-	-	-	-	-	-

(*) PM = dust, OGC = gaseous organic compounds, CO = carbon monoxide, NO_x = nitrous gases

(**) Only required when applying correction factors F(2) or F(3)

Signed for and on behalf of the manufacturer by:
Andreas Bloderer / product management

Micheldorf, 16.12.2021

RIKA[®]

Innovative Ofentechnik GmbH
A-4563 Micheldorf, Müllerviertel 20
Tel.: +43 (0)7582/686-14, Fax DW: -43
www.rika.at

Andreas Bloderer

In case of doubt as well as missing or incorrect translations, the German version is the only valid one.

Subject to technical and visual changes as well as layout and printing errors.

© 2021 | RIKA Innovative Ofentechnik GmbH

Contact details of the manufacturer

Manufacturer:	RIKA Innovative Ofentechnik GmbH
Contact:	Andreas Bloderer
Address:	Müllerviertel 20 4563 Micheldorf Austria

Details of the device

Model Identifier:	STEP 6 kW
Equivalent models:	-
Notified body:	Technische Universität Wien, Getreidemarkt 9/166, 1060 Wien, Austria
Notified body no.:	1746
Test report no.:	PL-18069-P
Applied harmonised standards:	EN13240:2001/A2:2004/AC:2007
Other applied standards/technical specifications:	-
Indirect heating functionality:	Nein
Direct heat output:	6 kW
Indirect heat output:	-

Characteristics when operating with the preferred fuel

Seasonal space heating energy efficiency η_s :	73,9 %
Seasonal space heating energy efficiency RIKATRONIC η_s :	-
Energy Efficiency Index:	112
Energy Efficiency Index RIKATRONIC:	-

Special precautions for assembly, installation or maintenance

Fire protection and safety distances such as distances to combustible building materials must be observed!
An adequate supply of combustion air for the appliance must be guaranteed at all times. Air-suction systems can interfere with the combustion air supply!
The flue gas values of the appliance must be observed for the chimney dimensioning!

Characteristics when operating exclusively with the preferred fuel

Heat output			
Nominal heat output	P_{nom}	6	kW
Minimum heat output	P_{min}	-	kW
Useful efficiency			
Useful efficiency at nominal heat output	$\eta_{th,nom}$	83,9	%
Useful efficiency at minimum heat output	$\eta_{th,min}$	-	%
Auxiliary electricity consumption*			
At nominal heat output	$e_{l,max}$	n.A.	kW
At minimum heat output	$e_{l,min}$	n.A.	kW
In standby mode	$e_{l,sB}$	n.A.	kW
Permanent pilot flame power requirement			
Pilot flame power requirement	P_{pilot}	n.A.	kW

*RIKATRONIC

Type of heat output/room temperature control	
single stage heat output, no room temperature control	Yes
two or more manual stages, no room temperature control (**)	No
with mechanic thermostat room temperature control (**)	No
with electronic room temperature control (**)	No
with electronic room temperature control plus day timer (**)	No
with electronic room temperature control plus week timer (**)	No
Room temperature control with presence detection (**)	No
Room temperature control with open window detection (**)	No
with remote control options (**)	No

Details of the fuel

Fuel	Preferred fuel:	Other suitable fuel:	η_s [%]	Space heating emissions at nominal heat output (*)				Space heating emissions at minimum heat output (*)(**)			
				PM	OGC	CO	NO _x	PM	OGC	CO	NO _x
				mg/Nm ³ (13% O ₂)				mg/Nm ³ (13% O ₂)			
Wood logs, moisture content ≤ 25 %	Yes	No	73,9	21	35	825	105	-	-	-	-
Wood logs RIKATRONIC, moisture content ≤ 25 %	No	No	-	-	-	-	-	-	-	-	-
Compressed wood, moisture content < 12 %	No	No	-	-	-	-	-	-	-	-	-
Other woody biomass	No	No	-	-	-	-	-	-	-	-	-
Non-woody biomass	No	No	-	-	-	-	-	-	-	-	-
Anthracite and dry steam coal	No	No	-	-	-	-	-	-	-	-	-
Hard coke	No	No	-	-	-	-	-	-	-	-	-
Low temperature coke	No	No	-	-	-	-	-	-	-	-	-
Bituminous coal	No	No	-	-	-	-	-	-	-	-	-
Lignite briquettes	No	No	-	-	-	-	-	-	-	-	-
Peat briquettes	No	No	-	-	-	-	-	-	-	-	-
Blended fossil fuel briquettes	No	No	-	-	-	-	-	-	-	-	-
Other fossil fuel	No	No	-	-	-	-	-	-	-	-	-
Blended biomass and fossil fuel briquettes	No	No	-	-	-	-	-	-	-	-	-
Other blend of biomass and solid fuel	No	No	-	-	-	-	-	-	-	-	-

(*) PM = dust, OGC = gaseous organic compounds, CO = carbon monoxide, NO_x = nitrous gases

(**) Only required when applying correction factors F(2) or F(3)

Signed for and on behalf of the manufacturer by:
Andreas Bloderer / product management

Micheldorf, 16.12.2021

RIKA[®]

Innovative Ofentechnik GmbH
A-4563 Micheldorf, Müllerviertel 20
Tel.: +43 (0)7582/686-14, Fax DW: -43
www.rika.at

Andreas Bloderer

In case of doubt as well as missing or incorrect translations, the German version is the only valid one.

Subject to technical and visual changes as well as layout and printing errors.

© 2021 | RIKA Innovative Ofentechnik GmbH

3. TECHNICAL DATA

Spare part overview exploded diagram

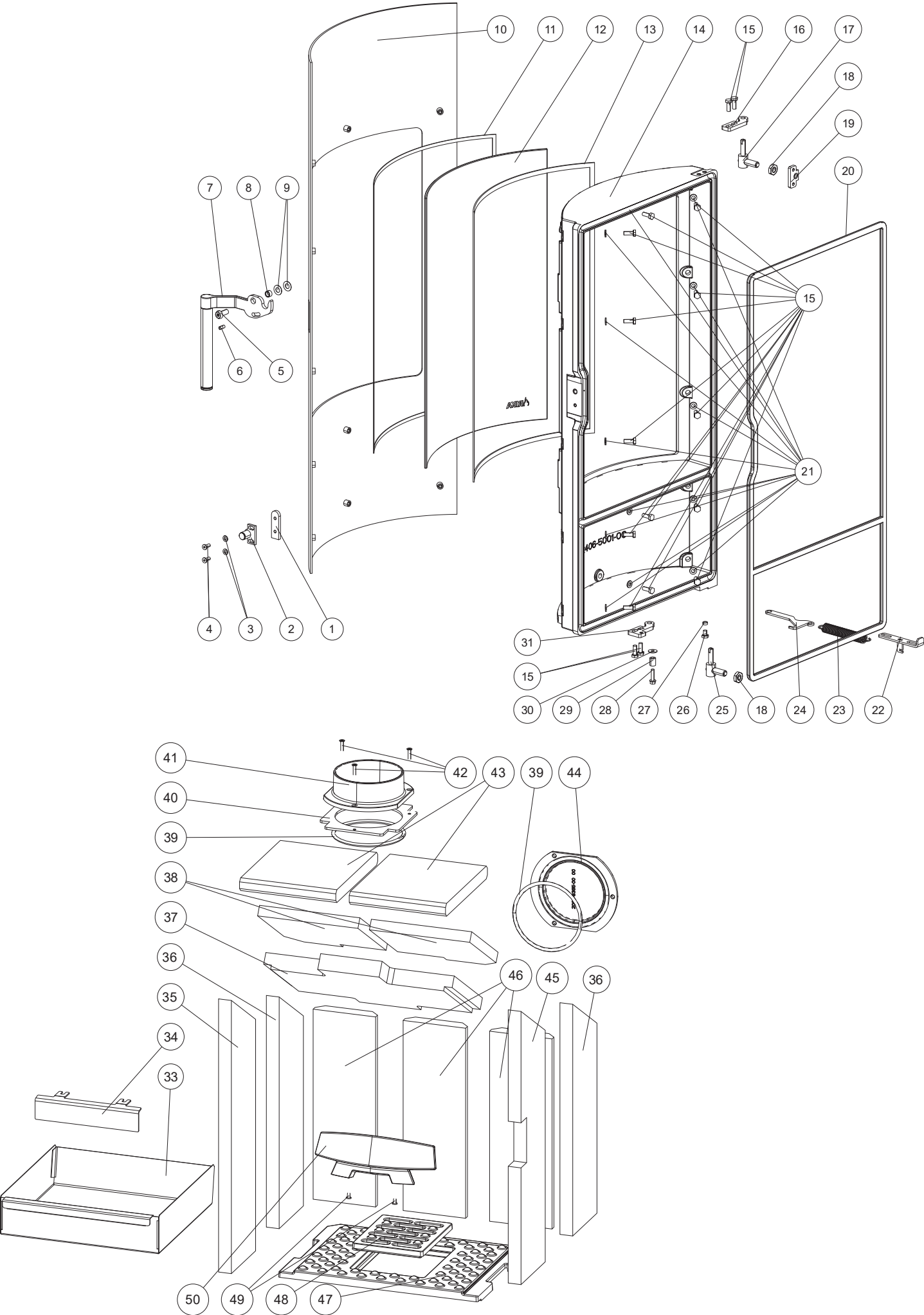

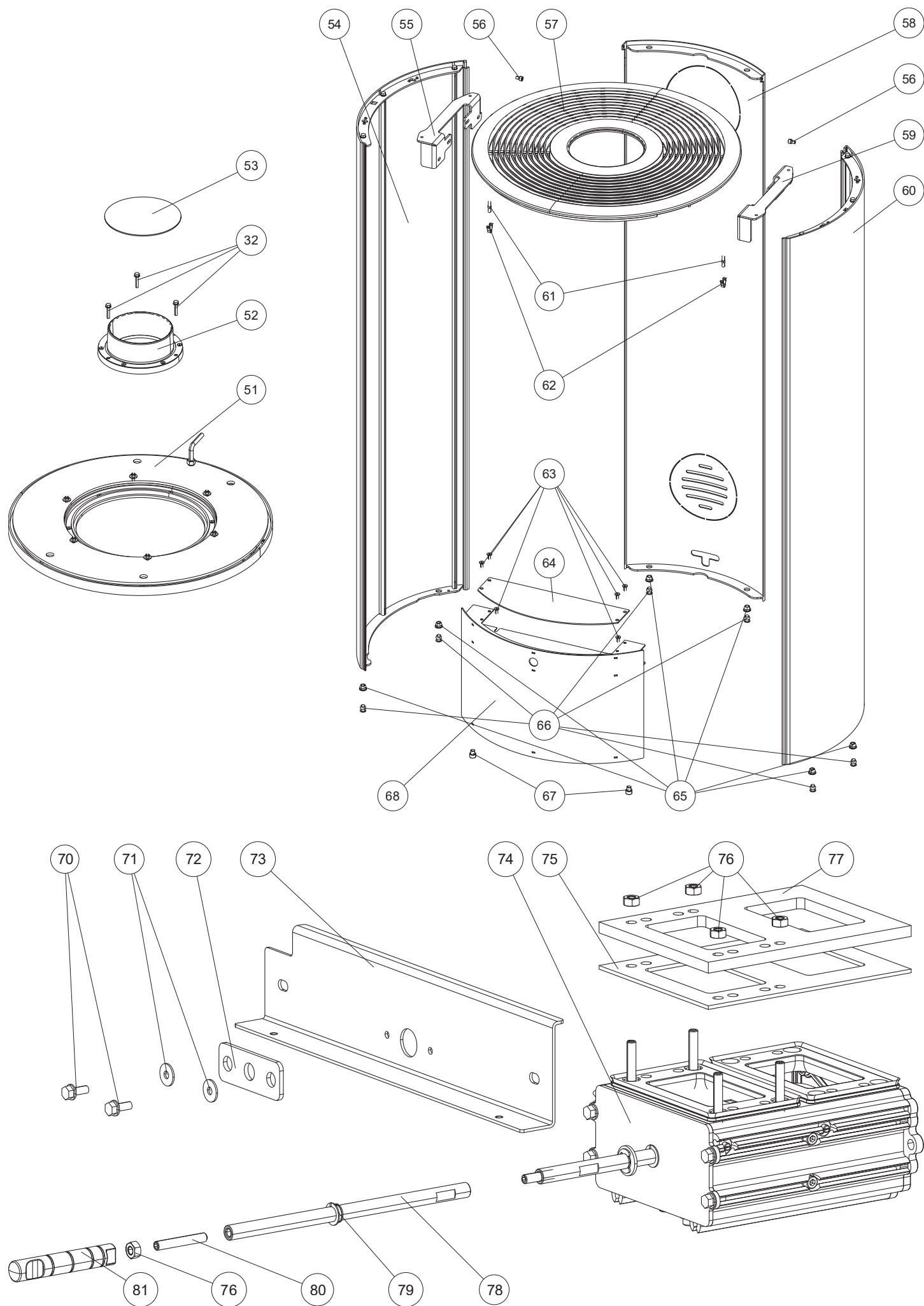

Spare part overview article numbers

Nr.	Art.Nr.	Description	Nr.	Art.Nr.	Description
1	Z37339	Retaining plate		N112251	Locking pin
2	Z37215	Locking bolt	52	B15959	Flue pipe attachments assy rotatable
3	N111965	Washer M05	53	E15697	Cover lid AH
4	N100751	Flat allen screw M05X12	54	B18491	Side casing panel, left
5	N109975	Hexagon socket screw M08X20	55	Z36399	Side casing retaining plate left
6	N108427	Headless screw M05X12	56	N111948	Hexagon socket screw M05X08
7	B18479	Door opener assy	57	B18376	Convection cover
8	Z14937	Handle sleeve	58	B18288	Rear wall
9	L03440	Spacer washer	59	Z36398	Side casing retaining plate right
10	B18287	Decorative door	60	B18492	Side casing panel, right
11	N100475	Flat packing white 8x2	61	N112127	Locking bolt
12	Z36870	Front door glass	62	Z36001	Snap spring
13	N103693	Flat seal black 8x2	63	N108485	Allen screw M05X10
14	Z36864	Combustion chamber door	64	Z37354	Cover
	B18372	Combustion chamber door assy	65	N112020	Grommet
15	N103964	Hexagonal screw M06x16	66	N111443	Blind rivet nut
16	L02811	Hinge plate top	67	N112027	Magnet
17	B15825	Hinge BA1	68	B18289	Cover panel, bottom
18	N111780	Hexagonal nut	70	N108313	Self-tapping screw M05x12
19	L03506	Hinge plate	71	N112009	Flat washer
20	N100485	Round sealing strip black D12	72	L03439	Bearing retainer
21	N112175	Washer	73	Z37350	Facing retainer
22	LB00646	Spring tensioner	74	B18318	Airbox assy
23	N111999	Tension spring (door)	75	Z37349	Spacer plate 5 mm
24	L02813	Door stop	76	N103988	Hexagonal nut M06
26	N112245	Hexagonal screw M06X08	77	Z37230	Spacer plate 10 mm
27	Z26257	Spacer	78	Z37220	Intermediate shaft
28	N112160	Self-tapping screw M05X20	79	N112195	Friction bearing
29	Z14922	Spacer	80	N111783	Grub screw
30	N112009	Flat washer	81	Z37304	Regulator handle
31	L02812	Hinge plate below			
32	N112305	Self-tapping screw M05x30			
33	L02793	Ash drawer			
34	Z36397	Cover panel			
35	Z36085	Firebrick lining front left, right			
36	Z36084	Firebrick lining rear left, right			
37	Z33588	Deflector plate bottom			
38	Z36094	Deflector plate top			
39	N111631	Round sealing cord grey D06			
40	Z35174	Sealing plate			
41	Z17799	Flue pipe attachment D130 black			
42	N112082	Self-tapping screw M05X20			
43	Z37229	Deflector			
44	Z35057	Blind cover black			
45	Z37249	Firebrick lining front right			
46	Z36083	Firebrick lining rear			
47	Z35812	Bottom plate			
48	Z35813	Grate			
49	N108830	Fillister head screw M05x08			
50	Z32940	Wood retainer black			
51	B17909	Rotary disc assy			
	Z36459	Locking lever			

Note: Please consider the powdercoated parts can differ slightly in colour and colour effects though they are elaborated in high quality. Minor damage to the trim parts can be repaired with our special Senotherm paint spray. There is no matching RAL colour for the painted fairing parts.

Dimensions

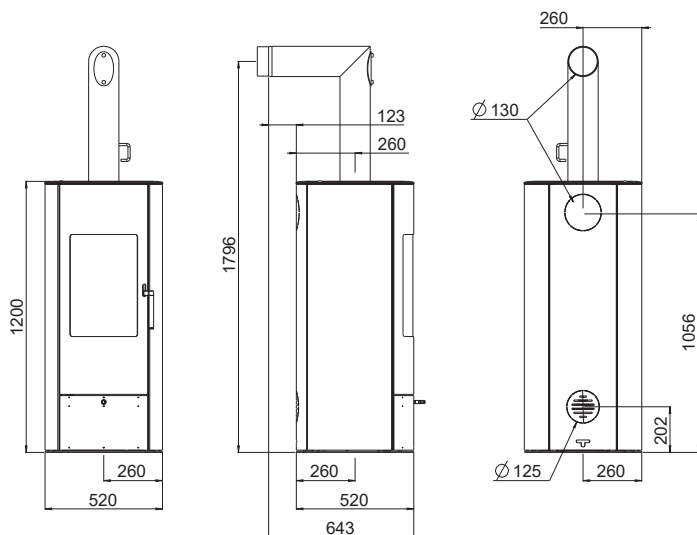

Dimensions

Height	[mm]	1200
Height with rotary disc	[mm]	1230
Width	[mm]	520
Corpus depth	[mm]	520

Weight

Weight with steel casing	[kg]	~145
Weight complete with rotary disc	[kg]	~155

Flue pipe connection

Flue pipe outlet	[mm]	130
Connection height	[mm]	1796
Connection height with rotary disk	[mm]	1820
Original angle pipe total depth	[mm]	643
Original angle pipe distance to rear wall	[mm]	123
Depth from rear wall to middle of flue pipe	[mm]	260
Original angle pipe side distance	[mm]	260
Rear connection height	[mm]	1056*
Rear connection side distance	[mm]	260*

Fresh air connection*

Diameter	[mm]	125*
Connection height	[mm]	202*
Side distance	[mm]	260*
Floor connection side distance	[mm]	260*
Floor connection depth	[mm]	260*

*not available with the rotary disc

Amount of Fuel

	Nominal load	Part load
Amount of fuel 8 kW	~2,2 kg**	~1,1 kg**
Amount of fuel 6 kW	~1,8 kg**	-

**Practical values may vary depending on wood quality.

Technical data

Technical data		8 kW	6 kW
Nominal heat output	[kW]	8	6
Partial heat output	[kW]	4	-
Fresh air demand	[m³/h]	21	16
Room heating capacity (depending on house insulation)	[m³]	90 - 210	70 - 160
Fuel consumption	[kg/h]	~2,2	~1,8
Efficiency	[%]	81,9	83,8
CO ₂	[%]	10,5	9,2
CO-emission on 13% O ₂	[mg/m _N ³]	677	824,5
Dust emission	[mg/m _N ³]	21	21
Exhaust	[g/s]	6,7	6
Exhaust temperature	[°C]	302,2	258
Chimney draft requirement	[Pa]	12	12

The owner of small firing systems or the person authorised for the small firing system is to keep the technical documentation and is to submit it to the authorities or the chimney sweep on request.

Note

Please observe the national and European standards as well as local regulations concerning the installation and operation of firing installations!

Packaging

Your first impression is important to us!

The packaging of your new stove provides excellent protection against damage. However damage to the stove and accessories may still occur during transport.

Note

Therefore please check your stove on receipt for damage and completeness! Report any deficiencies to your dealer immediately! Pay particular attention during unpacking that the stone panels remain intact. Scratches to the material can easily occur. Stone panels are excluded from the warrant.

The packaging of your new stove is environmentally neutral to a great extent.

Tip

The wood used in the packaging has not been surface treated. The cardboard and film (PE) can be disposed of via the municipal waste collection for recycling.

4. IMPORTANT INFORMATION

General warning and safety information

Observance of the introductory general warning information is imperative.

- Read the entire manual thoroughly before installing and putting the stove into service. Observe the national provisions and laws as well as the regulations and rules applicable locally.
- RIKA stoves should only be installed in rooms with normal humidity (dry areas according to VDE 0100 Part 200). The furnaces are not splash water protected and may not be installed in wet areas.
- Only approved transport equipment with sufficient load carrying capacity may be used with your heating appliance.
- Your heating appliance is not suitable for use as a ladder or stationary scaffolding.
- The burning of fuel releases heat energy that lead to extensive heating of the stove surfaces, doors, door and operating handles, glass, flue pipes and possibly the front wall. Refrain from touching these parts without appropriate protective clothing or equipment e.g. heat-resistant gloves or means of operation (operating handle).
- Make your children aware of this particular danger and keep them away from the stove during heating.
- Only burn approved heating materials.
- The combustion or introduction of highly flammable or explosive materials such as empty spray cans etc. in the combustion chamber and storing them near the stove is strictly prohibited due to the danger of explosion.
- No light or inflammable clothing is to be worn when post-heating.
- Use the heat-resistant gloves supplied to open the doors of your stove.
- Only use suitable tools from our range of accessories when handling embers and make sure that no embers fall out of the combustion chamber onto inflammable material.
- Push the embers together to form a firebed when you add new fuel (logs).
- Placing non-heat resistant objects on the stove or near it is prohibited.
- Do not place clothing on the stove to dry.
- Laundry racks etc. must be placed at a sufficient distance to the stove – ACUTE DANGER OF FIRE!
- When your stove is burning, the use of highly inflammable and explosive materials in the same or adjacent rooms is prohibited.

Note

Waste and liquids may not be burnt in the stove!

Note

To prevent your stove from overheating of the internal components, do never cover the convection fins!

Note

Your stove will expand and contract during the heating and cooling phase. This can sometimes lead to slight bending or cracking noises. This is normal and is no reason for a complaint.

First heating

The stove body, just as various steel parts, cast iron parts and the flue pipes are painted with a heat resistant paint. During the first heating the paint dries out completely. This may cause a slight smell. Touching or cleaning the painted surfaces during the curing should be avoided. The hardening of the paint is finished after the first heating with high power.

Safety distances

Note

1. To non-combustible objects
 $a > 40 \text{ cm}$, $b > 10 \text{ cm}$
2. To combustible objects and reinforced concrete load-bearing walls
 $a > 80 \text{ cm}$, $b > 15 \text{ cm}$

Tip

Please observe a minimum distance of 20 cm behind and sideways the stove for maintenance.

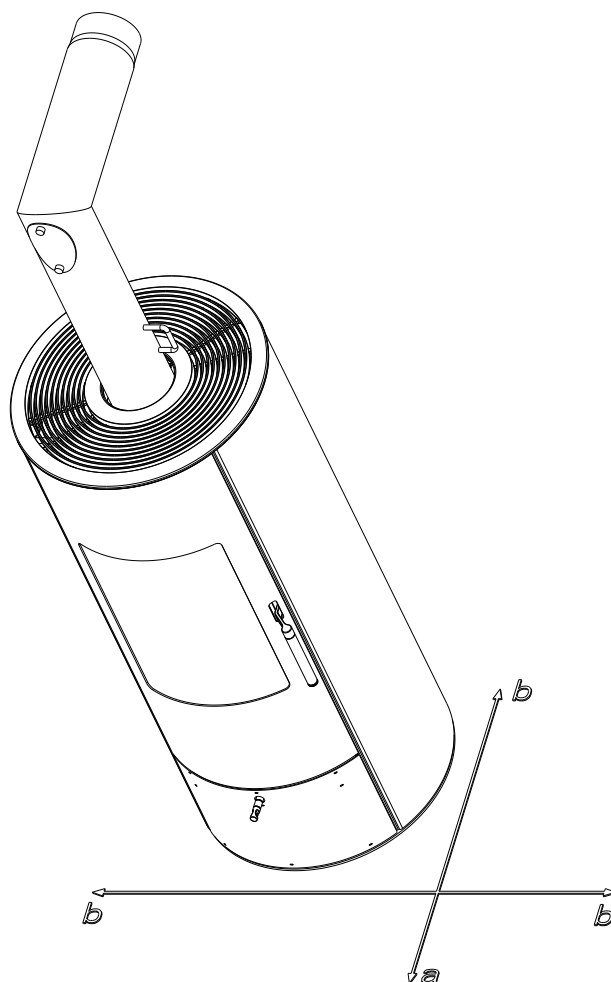

Prior to set up

Floor bearing capacity

Ensure that the substructure is capable of bearing the weight of the stove prior to set-up.

Note

No modifications may be made to the firing installation. This also leads to loss of warranty and guarantee.



Floor protection

A glass, sheet steel or ceramic plate is required, if the floor is combustible (wood, carpet, etc.).

Flue pipe connection

- Flue pipes pose a particular source of hazard regarding gas leaks and fire. Get the advice of an authorised specialist company for the layout and assembly.
- Please observe the corresponding installation guidelines for walls panelled with wood when connecting your flue pipes to the stove.
- Observe the formation of flue gas (atmospheric inversion) and draughts when the weather is unfavourable.
- Infeed of too little combustion air can lead to smoke in the rooms or to flue gas leaks. Hazardous deposits in the stove and chimney may also occur.
- If flue gas escapes, let the fire burn out and check whether all the air inlet openings are free and the flue gas pipes and the stove pipe are clean. If in doubt notify the master chimney sweep since draught malfunctions may be connected to your chimney.

Stoves type 1 (BA 1):

- Suitable for multiple occupancy. (Note the different country regulations.)
- These may only be operated with the combustion chamber door closed.
- The combustion chamber door may only be opened to add fuel and must then be closed again otherwise other firing installations connected to the chimney may be endangered.
- The combustion chamber door is to be kept closed when the stove is not in operation.
- Fouling of the chimney i.e. deposits of highly inflammable materials such as soot and tar and subsequently fire in the chimney may occur if wet fuel is used and operation is damped too much.
- If this occurs, close the fresh air support (slider, regulator, flaps - depending on model)! Disconnect the mains plug at the stoves type Rikatronik. Phone the fire brigade and get yourself and other residents out of harm's way.

Note

on ROOM-AIR DEPENDENT and ROOM-AIR INDEPENDENT OPERATION:

Your stove has been tested as a room-air independent stove according to EN 13240 and can be installed as well room-air dependent and independent.

When installed room-air dependent in combination with room-air installations (e.g. controlled ventilation and venting systems (extractors etc.) it must be ensured that the stove and the room air system are monitored and safeguarded mutually (e.g. via a differential pressure controller etc.). The combustion air infeed of approx. 20 m³/h must be ensured.

Please observe the respective local regulations and rules in consultation with your master chimney sweep. For changes after the printing of this manual, we can not assume any liability. We reserve the right to change without notice.

5. BRIEF INFORMATION ON COMBUSTIBLE - LOGS

Suitable fuels and fuel amounts

Your stove is generally suitable for burning dry firewood. You can also burn combustibles such as wood briquettes.

Note

A stove is not a waste incinerator. The warranty lapses if waste or non-approved materials such as plastic, treated wood (chipboard), coals or clothes are burnt! This leads to damage to the stove and chimney and to environmental pollution!

Note

FUEL AMOUNTS

The stove is fitted with a construction-specific flat firebox. This means only one layer of logs may be laid on the base embers. Please observe that adding greater quantities of logs leads to emission of high temperatures, higher than the stove is designed for. This may cause damage to your stove. This is reflected in particular on the glass of the combustion chamber door, which will get a gray haze in case of overheating the stove, which can not be removed.

Wood types

Different types of wood have different calorific values. Wood from deciduous trees is particularly suitable. It burns with a constant flame and forms long-lasting embers. Coniferous wood has higher levels of resin and burns off faster as do all softwoods and tends to spray sparks.

Wood type	Calorific value kWh/m³	Calorific value kWh/kg
Maple	1900	4,1
Birch	1900	4,3
Beech	2100	4,2
Oak	2100	4,2
Alder	1500	4,1
Ash	2100	4,2
Spruce	1700	4,4
Larch	1700	4,4
Poplar	1200	4,1
Robinia	2100	4,1
Fir	1400	4,5
Elm	1900	4,1
Willow	1400	4,1

Output controlling

The output of your stove is regulated manually or via the Rikatronik-control. Please observe that the output of your stove also depends on the chimney draught and the amount of fuel added.

Clean combustion

1. The firewood must be dry and untreated.

The should-be value is between 14 % and 18 % relative wood moisture.

Wood has to be stored dry and ventilated for 2–3 years.

2. Correct firewood amount and size:

- Too much firewood leads to overheating. This can damage your stove and increases the exhaust emission values.
- If you take too little firewood or if the logs you place are too large the stove will not reach the optimum operating temperature. The flue gas values also increase in this case.
- For right quantity of firewood see AMOUNT OF FUEL.

6. INSTALLING THE STOVE

Note

Assembly may only be performed by authorised specialist companies.

Note

Please observe the regional safety and building regulations. Please contact your master chimney sweep in this context.

Note

Only use heat-resistant sealing materials as well as corresponding sealing strips, heat-resistant silicon and rock wool.

Note

Also take care that the flue does not project into the free cross-section of the chimney.

Note

In case of room-air independent operation the stove pipe connections must be tightly sealed permanently. Use a heat-proof silicon to position the stove pipe on the conical supports of the flue tube nozzles and for insertion in the chimney flue lining.

Note

The stove should not be pushed on unprotected floors.

Tip

Strong corrugated cardboard, cardboard or e.g. old carpet is useful to assist assembly and as a base. The stove can also be pushed on this cardboard or carpet.

We recommend original flue pipes from RIKa for proper connection.

Connection to the chimney

- The device must be connected to a flue that is approved for solid fuels and is insensitive to moisture. The moisture insensitivity may vary if the flue calculation results in a dry operation. The chimney must have a diameter of min. 100 mm for pellet stoves and 130 mm -150 mm for log wood stoves depending on the diameter of the flue pipes.
- Avoid long flue pipes to the chimney. The horizontal length of the flue pipe should not exceed 1.5 metres.
- Avoid too many bends of the flue gas pipes. There should not be more than 3 bends in the exhaust pipe.
- Please use a connection with a cleaning opening.
- Connections must be made of metal and must meet the requirements of the standard (install the connections airtight).
- Before installing a chimney calculation must be made. The evidence must be performed for single occupancy to EN13384-1 and EN13384-2 for multiple occupancy.
- The maximum draft of the chimney should not exceed 15 Pa.
- The derivation of the flue gases must be guaranteed even during a temporary power outage.

Note

If connecting to multiple connection chimneys and depending on country regulations, additional safety equipment is required. Your local chimney sweep will advise you in this case.

Note

Be sure to prevent condensed water from entering via the flue connection. For combination stoves, a condensate collection pipe must be used for ceiling connection or flue pipe connection at the top. Damages caused by condensate are excluded from manufacturer's warranty.

Connecting to a steel chimney

The connection must be calculated and shown with EN13384-1 and EN13384-2.

Use only insulated (double) stainless steel tubes (flexible aluminum or steel tubes are not permitted).

An inspection door for regular inspection and cleaning must be present.

The flue pipe connection to the chimney has to be air-tight.

Combustion air

Every combustion process requires oxygen from the surrounding air. This so-called combustion air is removed from the living area in the case of individual stoves without external air connections.

This air removed must be replaced in the living space. Very tightly sealed windows and doors in modern flats may mean that too little air replaces that used. The situation also becomes problematical due to additional venting in flats (e.g. in the kitchen or WC). If you cannot feed in external combustion air, then air the room several times a day to prevent negative pressure in the room or poor combustion.

Feeding in external combustion air

only for devices which are able to run in room-air independent operation.

- Combustion air must be fed to the stove from outside via a sealed pipe for operation independent of the room air. According to EnEV, it must be possible to shut off the combustion air pipe. The open/closed setting must be clearly recognisable.
- Connect at the air intake either a pipe Ø 125 mm for log wood and combi stoves, or Ø 50 mm or Ø 60 mm for pellet stoves. Fix it with a hose clamp (not included!). At pellet stoves with longer intake pipes than 1 m the diameter should be increased to 100 mm. (see RIKa range).
- To ensure sufficient air intake, the intake pipe should not exceed max. 4 metres and have max. 3 bends.
- If the line leads outside it must have a windbreak.
- In extreme cold pay attention to icing on the air intake opening (check).
- It is also possible to suction in combustion air directly from another sufficiently vented room (e.g. cellar).
- The combustion air pipe must be tightly connected (adhesive or cement) permanently to the air nozzles of the stove.
- If you do not use the stove for a long time, please close the combustion air intake to prevent the stove from moisture.

Note

Please note that problems may arise due to updrafts in the case of combustion air supply from an integrated chimney ventilation shaft. If the combustion air flowing downwards is heated it may rise and thus counter the chimney with a resistance which in turn reduces the negative pressure in the combustion chamber. The chimney manufacturer is to guarantee that the resistance for the combustion air is a maximum 2 Pa even in the least favourable operating state of the chimney.

If one or more of these conditions does NOT apply, the result is poor combustion in the stove and negative pressure in the installation room.

7. OPTION REAR CONNECTION

Note

Only work on the unit when the mains plug has been disconnected and the stove has cooled down completely.

Note

During any conversion work, take particular care of your fingers and any panels and stove attachments. Select soft bases to prevent scratches to your living space furniture and stove panels.

Converting to rear flue pipe connection

(to be ordered separately)

Remove the convection fins.

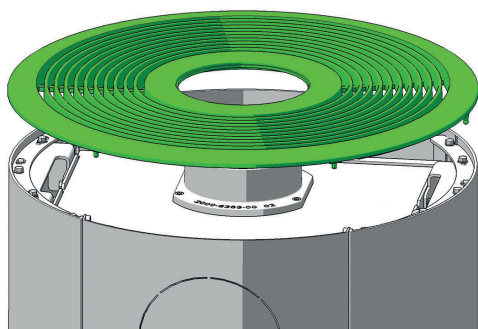

Lift the rear wall and cut it out along the perforation.

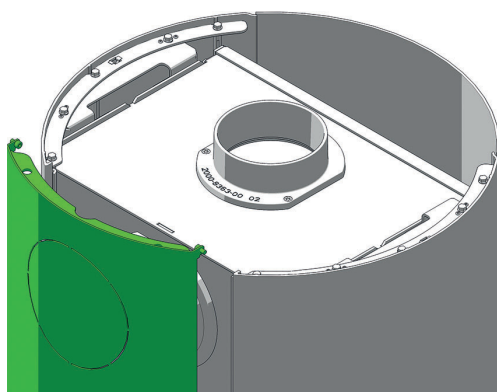

Replace the flue outlet from the top and the rear cover against each other.

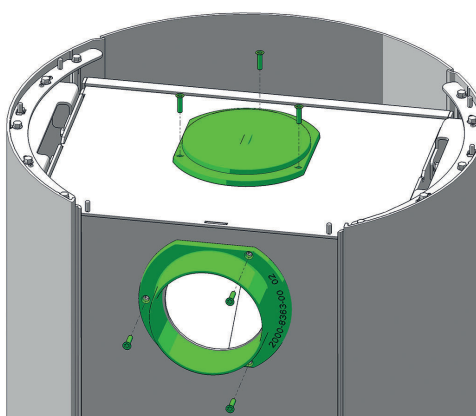
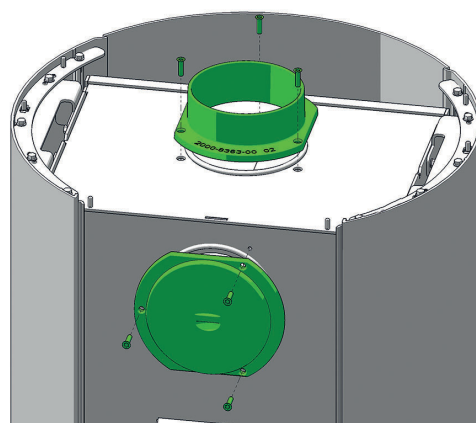

Note

Make sure that everything is air tight!

Replace the rear wall and the convection cover. At the end put the cover lid (to be ordered separately) onto the convection cover.

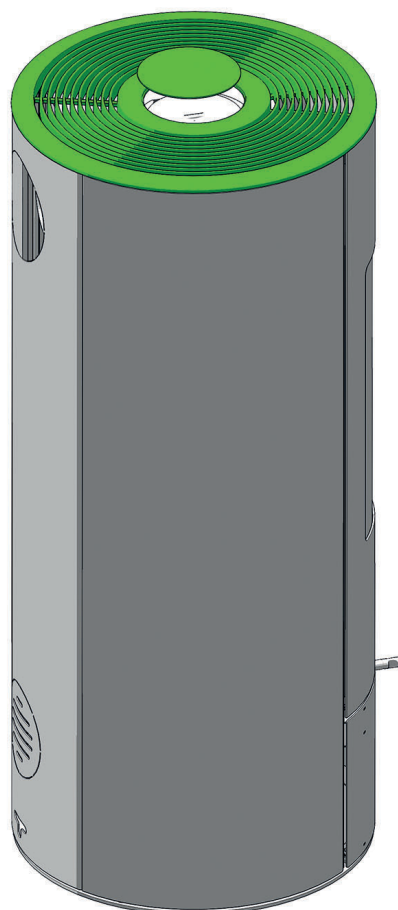

8. VARIATION ROTATION

Lift the locking bolt at the rear side from its initial position using the handle.

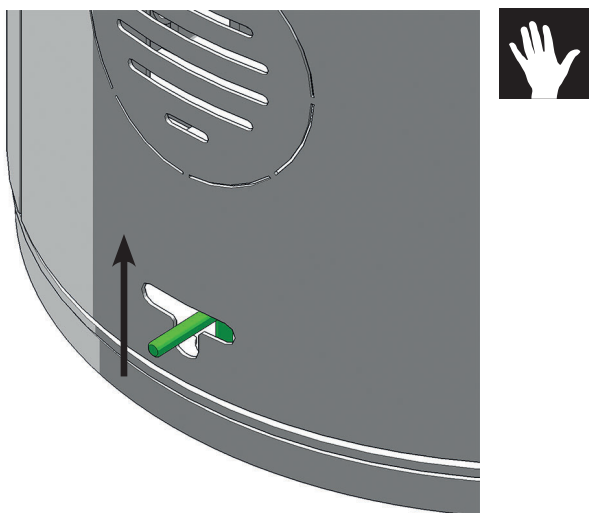

Swivel the stove. For better handling, put the handle aside for a moment.

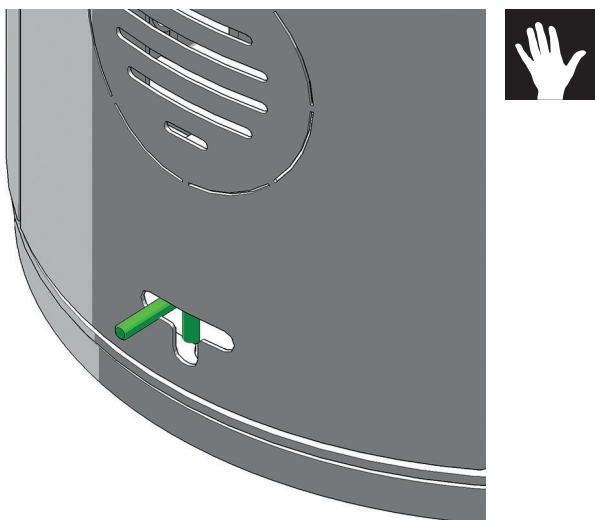

If you have roughly reached the desired end position, place the handle back in the centre again. Now turn until the locking bolt engages into the bottom plate. Positioning is possible in 30 degree intervals.

Note

Be sure that the stove is secured properly!



9. MANUAL OPERATION

Each combustion process needs oxygen. Before ignition the combustion chamber must be regularly cleaned from ash to ensure an adequate supply of air.

The right fill amount for heating up is 2 - 3 logs of the quantity given in AMOUNT OF FUEL.

Correct heating up primarily according to instructions counteracts excessive smoke during heating up.

RIKA firelighter

Always ignite the RIKA firelighter on the red tip. One block consists out of 8 ribs which can be divided to the desired size. The amount of RIKA firelighters also depends on the size and humidity of your firewood. Ideally, one rib is enough to light up the fire.



Tip

You can order the RIKA firelighter with the number E17159 at your RIKA dealer.



Combustion air regulation

The performance of your stove also depends on the chimney draught; therefore the control knob for combustion air regulation must be used according to your own experience.

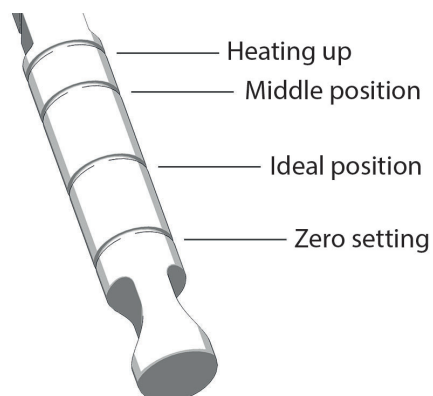

Heating up position

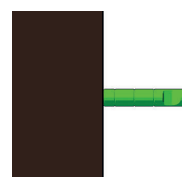

Middel position

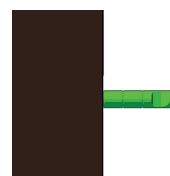

Ideal position

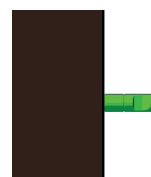

The heating-up position may only be used for heating up or refilling.

If the stove is not in use, warm air can release through the chimney. The zero setting of the control knob can prevent this.

Zero setting

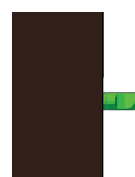

Correct heating up

1. Pull the control knob completely to "heating-up position". Open the combustion chamber door and sweep the ashes into the ashtray.

Place left and right two small pieces of chipboard lengthways in the bottom of the combustion chamber.

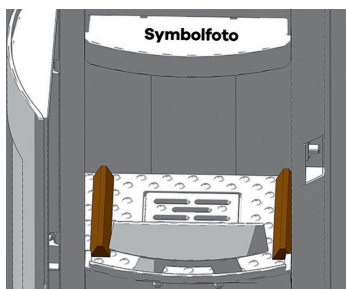

Place two logs crossways on top of this chipboard.

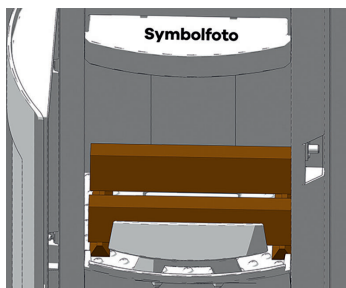

2. Now place further pieces of chipboard in crosswise layers on top of the logs and place 2-4 ribs of the RIK-A-firelighter on top of the chipboard. Some uncoated paper can be placed underneath the chipboard in case there is no firelighter available.

3. Now light the firelighter (or the uncoated paper) and close the combustion chamber door.

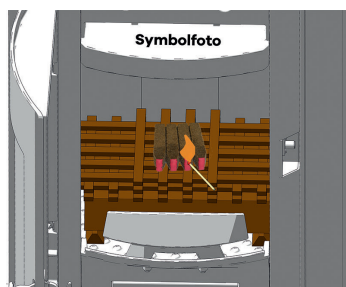

Set the control knob for combustion air regulation to middle position some minutes later. If the logs are well lit the control knob can be set to ideal position another few minutes later (depending on draught and fuel quality / amount).

Refilling

After the first burn-off, add one or two logs (see AMOUNT OF FUEL) to the blaze. Set the control knob to heating-up position again until the wood is well lit.

Note

Sometimes a lot of smoke develops when wood is placed on a low firebed or when there is too less fresh air for combustion. An explosive gas/air mixture may arise and cause an eventual heavy deflagration. For safety reasons it is recommended to leave the combustion chamber door closed and press the control knob at the rear wall down completely into "heating-up position". If the log wood is not igniting, start a new heating-up procedure after it stopped smoking.

Please proceed in the same way for every further addition of wood.

10. CLEANING AND MAINTENANCE

Basic information

Note

When you vacuum clean around the stove ensure that you do not vacuum into the combustion air intake during heating operation. You could vacuum out embers – FIRE RISK!

Note

Your stove must be cooled before any maintenance work is performed.

Tip

Your RIKA dealer will gladly advise you about their service and maintenance offers.

The frequency with which the stove requires cleaning and the maintenance intervals depend on the fuel you use. High moisture content, ash, dust and chips may more than double the maintenance required. Only use wood that has been stored properly and is dry and untreated.

Note

Ash may contain embers – only place ash in sheet steel containers. FIRE RISK! In a cold state, dispose it of in the household waste.

Cleaning the combustion chamber

The combustion chamber must be regularly cleaned from ash to ensure an adequate supply of air. If you swing the grate open, you can sweep the ashes with a broom in the ash tray. You can also use an ash vacuum cleaner.

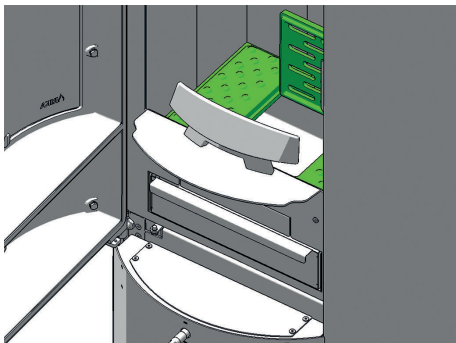

Note

Only when the stove is cold! You could vacuum out embers – FIRE RISK!

Empty the ash drawer

Empty the ash drawer regularly. The ash drawer is simply pulled forward with the combustion chamber door open.

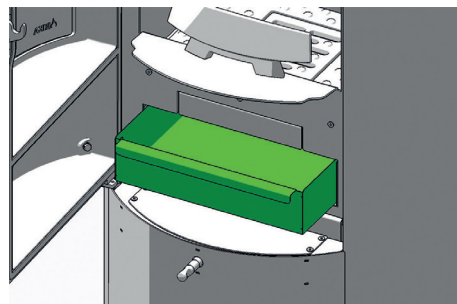

Cleaning the door glass

The glass can be cleaned best with a moist cloth. Stubborn dirt can be removed with a special cleaner (free from corrosive acids and solvents – otherwise there is a risk of damage to the glass surface) available from your stove dealer. Usual cleaners containing acid or solvents can be too harsh and damage the glass.

Note

Never use abrasive or aggressive cleaning agents to clean the wooden door handle, these will damage the wood.

Cleaning painted surfaces

Wipe the painted surfaces with a damp cloth, do not scrub. Do not use solvent-containing cleaners.

Cleaning the convection air openings

Vacuum clean any dust deposits from the convection air openings at regular intervals.

The stove should be cleaned thoroughly prior to the start of the heating season to prevent excess odour.

Cleaning the flue pipes

annually!

Remove the flue pipes. Inspect and clean the chimney connection. Brush off any soot and dust deposits in the fire and in the flue pipes and vacuum.

Install the removed parts in reverse order.

Note

Accumulated fly ash in the flue gas channels may impair the performance of the stove and pose a safety risk.

Checking door seal

annually!

The condition of the seals at doors and glass should be checked at least once a year. Repair or replace seals depending on condition.

Note

Only intact seals ensure your stove works perfectly!

11. PROBLEMS - POSSIBLE SOLUTIONS

Problem 1

Fire burns with weak, orange flame, window is sooted up.

Cause(s)

- Poor chimney draught
- Damp wood
- Incorrect heating up
- Stove is sooted over inside

Possible solutions

- Check whether flue gas pipes are blocked with ash (see CLEANING AND MAINTENANCE).
- Use dry wood and correct fuel amounts (see BRIEF INFORMATION ON COMBUSTIBLE - LOGS)
- Check whether the suction nozzles and air inlet pipe or flue tube are blocked.
- Check door and cleaning cover seals for leaks (see CLEANING AND MAINTENANCE)
- Have service performed by authorised specialist company.
- Every glass plate must be cleaned from time to time (depending on use) with glass cleaner.

Problem 2

Stove smells strongly and / or fumes are emitted.

Cause(s)

- Burning-in phase (taking into service)
- Stove has accumulated dust and/or dirt

Possible solution(s)

- Wait to end of burning-in phase and vent sufficiently
- Suction off any dust deposits from the convection air openings at regular intervals

Problem 3

Flue gas discharge when wood is added and during heating phase.

Cause(s)

- Combustion chamber door opened too fast
- Too much ash in combustion chamber
- Adding logs to snappy
- Chimney draught too low
- Flue pipe connection leaks
- Logs combustion still running (visible flame)

Possible solution(s)

- open the combustion chamber door moderate
- regular cleaning of combustion chamber (vacuum)
- Adding logs carefully
- Check chimney
- Check connections and if necessary re-seal
- Add logs after flame is gone
- Check seals and replace (fire door, ..)

12. GUARANTEE CONDITIONS

We recommend having the installation performed by a RIKA-certified technician.

These guarantee conditions only apply for the European mainland. For all other countries, the separate conditions of the importer in the respective country apply. In cases of doubt, or in the case of missing or incorrect translations, the German version is always the sole valid version.

In the interest of ensuring damage limitation in good time, the guarantee claim should be sent in writing to the RIKA specialist or contract dealer.

In this event, the following documents must be presented:

- Written reason for complaint
- Invoice
- Commissioning record
- Model name and serial number

RIKA GUARANTEE

5 YEARS

on the welded stove body.

Up to 5 years or 10,000 kg of consumed pellets for pellet stoves.

The RIKA guarantee is a commercial or manufacturer's guarantee (subject to certain exceptions).

This relates exclusively to defects in the material and processing, and to the supply of replacement parts free of charge. Working hours and travel times are not covered by the manufacturer's guarantee.

The guarantee is conditional on the following:

- Only original parts supplied by the manufacturer must be used.
- Professional installation of the stove in compliance with the respective operating manual valid at the time of purchase.
- The stove must be connected by a professional certified for that type of stove.
- The commissioning is performed by a RIKA-certified technician.

If these points are not complied with, the guarantee claim is void!

Any costs incurred by the manufacturer as a result of an unjustified guarantee claim will be charged back to the claimant. Likewise excluded from the guarantee is any damage resulting from or caused by non-compliance with the manufacturer's instructions for operating the appliance, e.g. overheating, use of non-approved fuels, unprofessional interference with the appliance or the flue pipe, a flue suction that is incorrectly adjusted to the appliance or is insufficient or too strong, condensation water, non-performance of or inadequate maintenance or cleaning, non-compliance with the applicable building regulations, improper operation by the operator or third parties, transport and handling damage.

STATUTORY WARRANTY PROVISIONS REMAIN UNAFFECTED BY THE GUARANTEE!

13. WARRANTY CONDITIONS

As a consumer, you are entitled to the warranty, which covers any defects at the time of delivery. The warranty is two (2) years from the date of delivery of the stove.

See the respective general terms and conditions of business and warranty conditions of the RIKA dealer.

The warranty does not cover:

1. Wearing parts (normal wear and tear not resulting from a defect)
2. Parts in contact with fire, e.g. glass, combustion troughs, grates, baffle plates, deflectors, combustion chamber cladding (e.g. refractory clay), ceramics, ignition elements, sensors, combustion chamber sensors and temperature monitors
3. Paint, surface coatings (e.g. handles, cover panels)
4. Seals
5. Natural stone, thermal stone, etc.

valid from: 01.07.2023

14. DISPOSAL INFORMATION

RIKA Innovative Ofentechnik GmbH is ensuring that its products are eco-friendly throughout the product life cycle. This is why our commitment for electronic products goes beyond the end of their product life cycle.

Note

For proper disposal of the device, we recommend contacting a local waste disposal company.

Note

Please contact your RIKA specialist dealer for professional disassembly/dismantling of the device.

Note

We recommend that you remove the parts that come into contact with the fire, such as glass, fire trough, grates, draught plates, baffle plates, combustion chamber linings (e.g. fireclay), ceramics, ignition elements, sensors, combustion chamber sensors and temperature monitors and dispose of them in the household waste.

Information on the individual components of the device

- **Electrical or electronic components:** Remove the electrical or electronic components from the device by disassembling them. These components must not be disposed of in the residual waste. Proper disposal should be carried out via the waste electrical equipment take-back system.
- **Fireclay in the combustion chamber:** Remove fireclay components that have been installed in the combustion chamber from the appliance. If present, fastening elements must be removed beforehand. Fireclay components that come into contact with the fire or flue gas must be disposed of; reuse or recycling is not possible.
- **Vermiculite in the combustion chamber:** Remove vermiculite that has been installed in the combustion chamber from the appliance. If present, fastening elements must be removed beforehand. Vermiculite in contact with fire or flue gas must be disposed of; reuse or recycling is not possible.
- **Glass ceramic pane:** Remove the glass ceramic pane using a suitable tool. Remove the seals and separate them from the frame if present. Transparent glass ceramic can generally be recycled, but must be separated into decorated and non-decorated panes. The glass ceramic pane can be disposed of as construction waste.
- **Sheet steel:** Disassemble the sheet steel components of the device by unscrewing or flexing (alternatively by mechanical crushing). If present, remove the seals beforehand. Dispose of the sheet steel parts as metal scrap.
- **Cast iron:** Disassemble the components of the cast iron device by unscrewing or flexing (alternatively by mechanical crushing). If present, remove gaskets beforehand. Dispose of the cast parts as metal scrap.
- **Natural stone:** Remove existing natural stone mechanically from the unit and dispose of as construction waste.
- **Gaskets (glass fibre):** Remove the gaskets mechanically from the device. These components must not be disposed of with residual waste, as waste glass fibre cannot be destroyed by incineration. Dispose of gaskets as glass and ceramic fibres (artificial mineral fibres).
- **Metal handles and decorative elements:** If present, remove or dismantle metal handles and decorative elements and dispose of them as metal scrap.

Note

Please observe the local disposal possibilities for all components.

Extract from the waste code of the European Waste List Regulation

Waste code	Waste type
15 01 03	Wooden packaging
17 01 03	Tiles and ceramics
17 02 02	Glass
17 04 05	Iron and steel
17 05 04	Soil and stones

NE

Electronic Waste

In accordance with the European Directive (2012/19/EU) Waste Electrical and Electronic Equipment (WEEE) and other local regulations, RIKA supports the setup of take-back systems and recycling infrastructures.

Old devices can easily be returned to the municipal waste collectors for recycling purposes. Please observe the national regulations to that end.



The device may not be disposed of in the normal household waste.

15. COMPLIANCE WITH EU REGULATIONS



This product complies with the requirements of the European Community.

Hereby, RIKA Innovative Ofentechnik GmbH declares that this device is in compliance with the essential requirements and other relevant provisions of Directive 2011/1185/EU.

The most recent and valid version of the DoC (Declaration of Conformity) can be viewed at www.rika.at.



RIKA Innovative Ofentechnik GmbH

Müllerviertel 20

4563 Micheldorf / AUSTRIA

Tel.: +43 (0)7582/686 - 41, Fax: -43

verkauf@rika.at

www.rika.at

In case of doubt as well as missing or incorrect translations, the German version is the only valid one. Subject to technical and visual changes as well as layout and printing errors..

© 2024 | RIKA Innovative Ofentechnik GmbH