

Data sheet

TRIO



Technical data		
Nominal heat output	[kW]	8
Partial heat output	[kW]	4
Fresh air demand	[m³/h]	21
Room heating capacity (depending on house insulation)	[m³]	90-210
Fuel consumption	[kg/h]	1,1-2,2
Efficiency	[%]	≥ 80
Energy efficiency class		A+
Energy efficiency index		n.s.
Chimney draft requirement	[Pa]	12

Characteristics

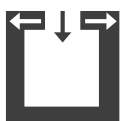

Balanced flue



RLS system



Energy
efficiency



Optional



Flue pipe
connection top



RIKI CLEAR VIEW

Dimensions, weight and connection

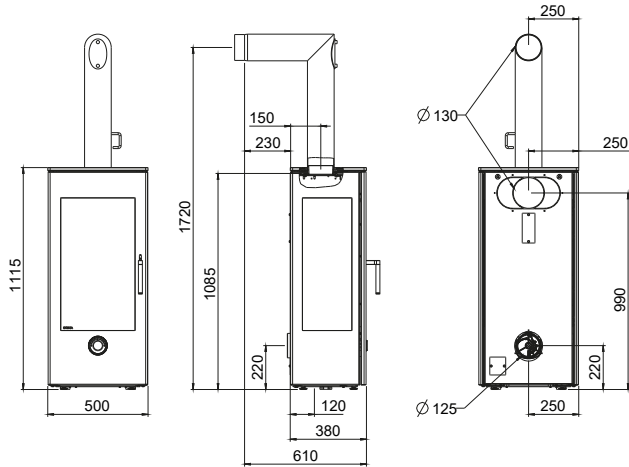

Dimensions			
<i>H</i>	Height	[mm]	1115
<i>L</i>	Length / depth	[mm]	380
<i>W</i>	Width	[mm]	500
	Firing chamber [WxHxD]	[mm]	390x460x250
Weight			
<i>m</i>	Mass of fireplace with steelshell	[kg]	141
<i>m_{chim}</i>	Maximum load through the chimney	[kg]	n.s.
Flue pipe connection			
<i>d_{out}</i>	Diametre of the flue gas connection	[mm]	130
	Original angle pipe connection height	[mm]	1720
	Original angle pipe total depth	[mm]	610
	Original angle pipe distance to rear wall	[mm]	230
	Depth from rear wall to middle of flue pipe	[mm]	150
	Original angle pipe side distance	[mm]	250
	Rear connection height	[mm]	990
	Rear connection side distance	[mm]	250
Fresh air connection			
	Diameter	[mm]	125
	Connection height	[mm]	220
	Side distance	[mm]	250
	Floor connection side distance	[mm]	250
	Floor connection depth distance	[mm]	120

* standard with rear connection.

Minimum distances to combustibile materials

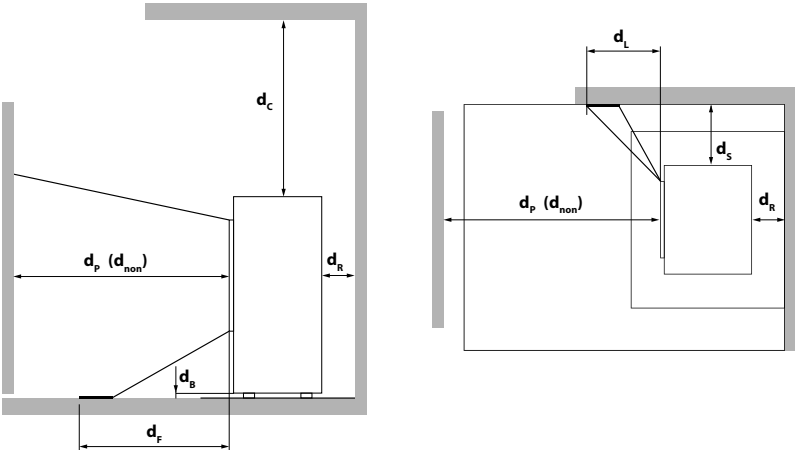

<i>d_R</i>	[mm]	100
<i>d_S</i>	[mm]	800
<i>d_C</i>	[mm]	750
<i>d_P</i>	[mm]	800
<i>d_F</i>	[mm]	0
<i>d_L</i>	[mm]	200
<i>d_B</i>	[mm]	0
<i>d_{non}</i>	[mm]	400 ¹

¹ to non-combustibile materials



In case of doubt as well as missing or incorrect translations, the German version is the only valid one.
Subject to technical and visual changes as well as layout and printing errors.