

Data sheet

TRIO RIKAir



| Technical data | | |
|---|----------|---------|
| Nominal heat output | [kW] | 8 |
| Partial heat output | [kW] | 4 |
| Fresh air demand | [m³/h] | 21 |
| Room heating capacity (depending on house insulation) | [m²] | 90-210 |
| Fuel consumption | [kg/h] | 1,1-2,2 |
| Electric supply | [V]/[Hz] | 230/50 |
| Average electrical input | [W] | n.s. |
| Fuse | [A] | n.s. |
| Efficiency | [%] | ≥ 80 |
| Energy efficiency class | | A+ |
| Energy efficiency index | | n.s. |
| Chimney draft requirement | [Pa] | 12 |

Characteristics

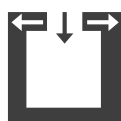

Balanced flue



RLS system



Energy efficiency



Optional

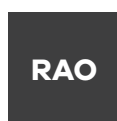

Flue pipe connection top



RIKA CLEAR VIEW



RIKAair

Dimensions, weight and connection

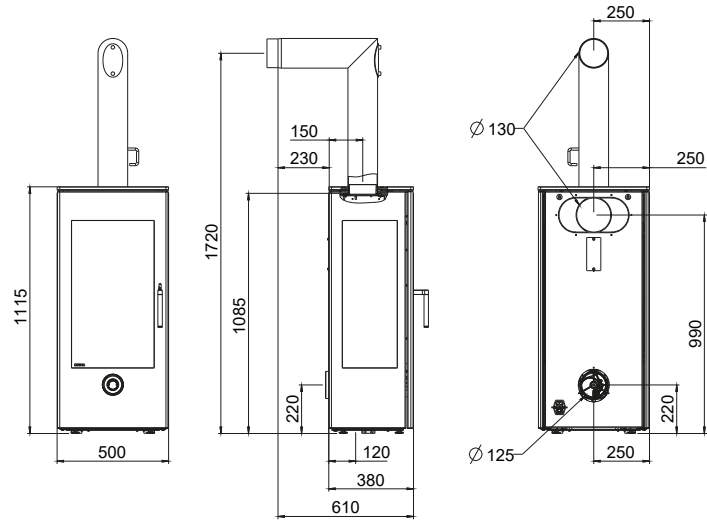

| Dimensions | | | |
|----------------------|---|------|-------------|
| H | Height | [mm] | 1115 |
| L | Length / depth | [mm] | 380 |
| W | Width | [mm] | 500 |
| | Firing chamber [WxHxD] | [mm] | 390x460x250 |
| Weight | | | |
| m | Mass of fireplace with steelshell | [kg] | 180 |
| m_{chim} | Maximum load through the chimney | [kg] | n.s. |
| Flue pipe connection | | | |
| d_{out} | Diametre of the flue gas connection | [mm] | 130 |
| | Original angle pipe connection height | [mm] | 1720 |
| | Original angle pipe total depth | [mm] | 610 |
| | Original angle pipe distance to rear wall | [mm] | 230 |
| | Depth from rear wall to middle of flue pipe | [mm] | 150 |
| | Original angle pipe side distance | [mm] | 250 |
| | Rear connection height | [mm] | 990 |
| | Rear connection side distance | [mm] | 250 |
| Fresh air connection | | | |
| | Diameter | [mm] | 125 |
| | Connection height | [mm] | 220 |
| | Side distance | [mm] | 250 |
| | Floor connection side distance | [mm] | 250 |
| | Floor connection depth distance | [mm] | 120 |

* standard with rear connection

Minimum distances to combustibile materials

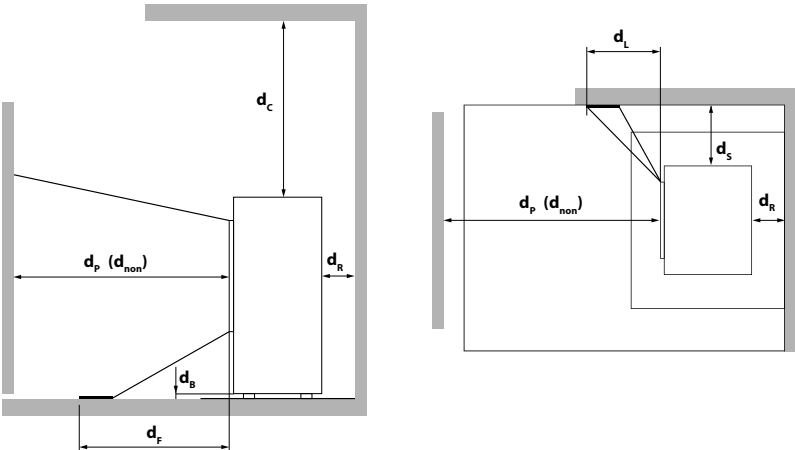

| | | |
|-----------|------|------------------|
| d_R | [mm] | 100 |
| d_S | [mm] | 800 |
| d_C | [mm] | 750 |
| d_P | [mm] | 800 |
| d_F | [mm] | 200 |
| d_L | [mm] | 200 |
| d_B | [mm] | 0 |
| d_{non} | [mm] | 400 ¹ |

¹ to non-combustibile materials

